

Project Manager: Michael Husar
Architect: Ann Beha Architects
Project Size: 32,650
Location: Myron Taylor Hall Complex

Project Description:

This project is needed because prior studies over the last seven years have demonstrated that the Cornell Law School (CLS) does not have enough space or appropriate space in which to conduct its mission currently and into the future (5-10 years). A revised concept for CLS space needs shifts immediate priorities from renovating Hughes to building new classrooms under the east lawn as Phase I, renovations to Myron Taylor Hall as Phase II and renovation of Hughes Hall as Phase III. Hughes will serve as swing space for the first two phases. These three phases will increase the CLS gross area by approximately 43,325 GSF and bring CLS to a total of 265,090 GSF compared to 302,865 GSF envisioned in the H&R plan.

Project Status:

To meet the 10 year space needs for the Law School, the Architect has developed three schemes. The Law School has selected the least expensive of the three schemes as their preferred space solution. The scheme proposes to make new classrooms and a new entry on College Avenue as the first priority in Phase I, renovations to Myron Taylor Hall as Phase II and the renovation of Hughes Hall as Phase III. Hughes will serve as swing space for the first two phases. A revised concept and design authorization was approved at the May B&P meeting.

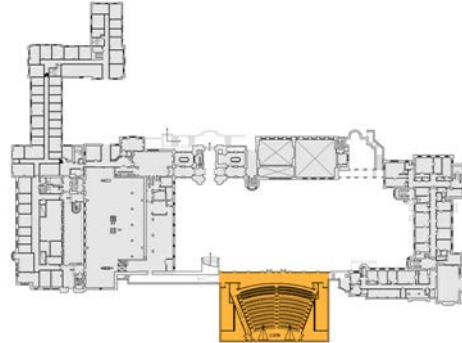

Phase 1: East Infill Auditorium

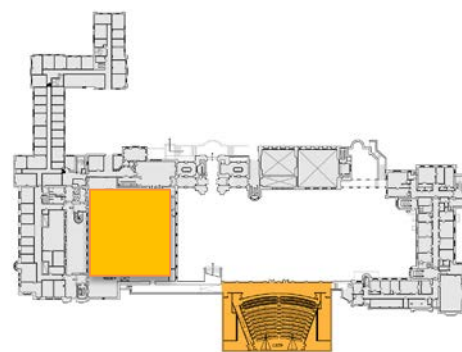

Phase 2: Myron Taylor Renovations

Approvals to Date: **CF&PC**
B&P

Concept Phase	Sep 10	Oct 10
Site Selection	Sep 10	Oct 10
Site Guidelines	Sep 10	Oct 10
SD Authorization	Sep 10	Oct 10
Revised Design Authorization	May 11	

Project Milestones: **Start** **End**

A/E Selection:		Oct 10
Concept Study	Nov 10	Apr 11
Schematic Design	Jul 11	Sep 11
DD, CD & Bid	Oct 11	May 12
Construction	Jun 12	Dec 14